

WHITE - COMMAND

ONE-WAY SWITCHES

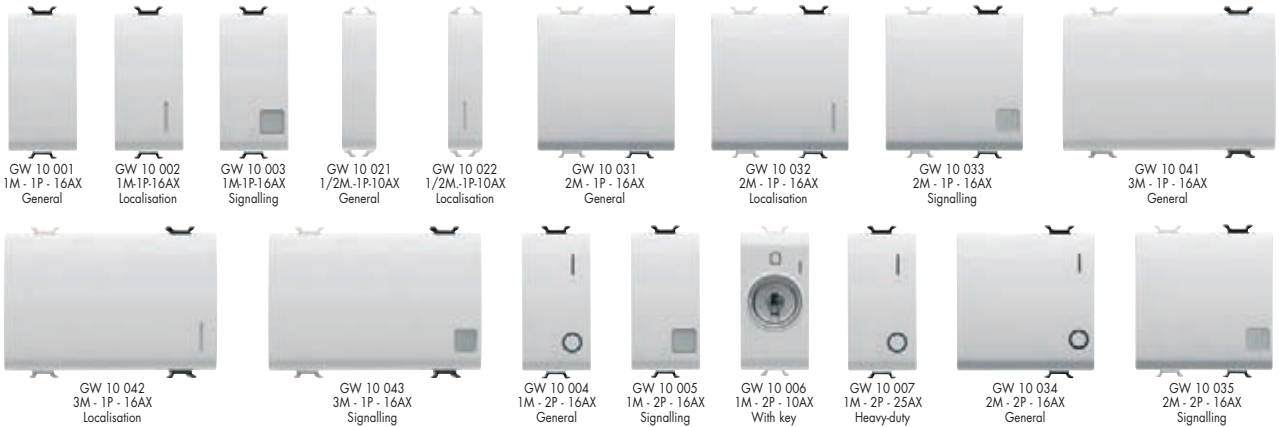

TWO-WAY SWITCHES

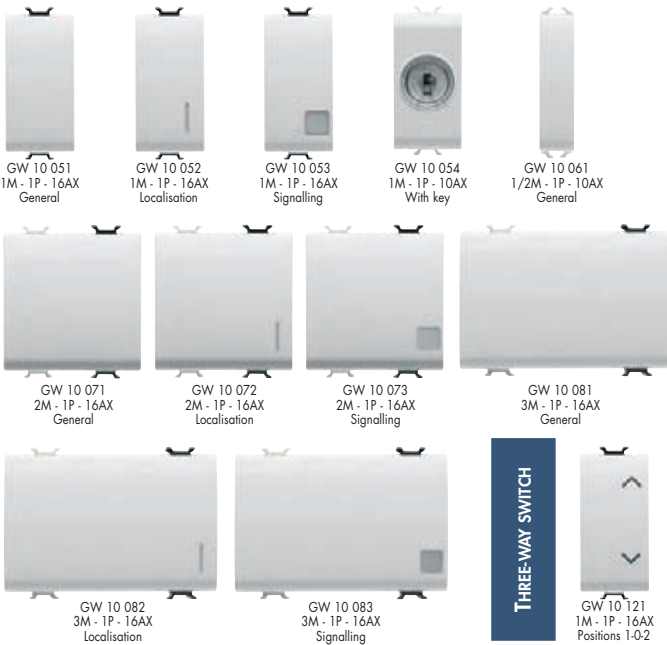

REVERSING SWITCHES

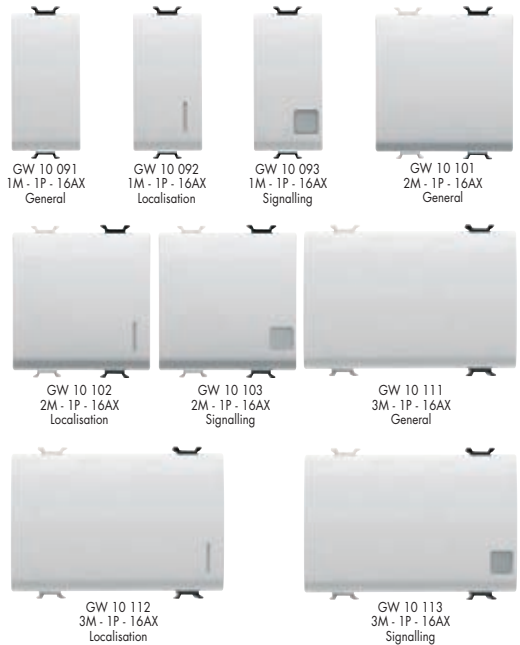

THREE-WAY SWITCH



PUSH-BUTTONS

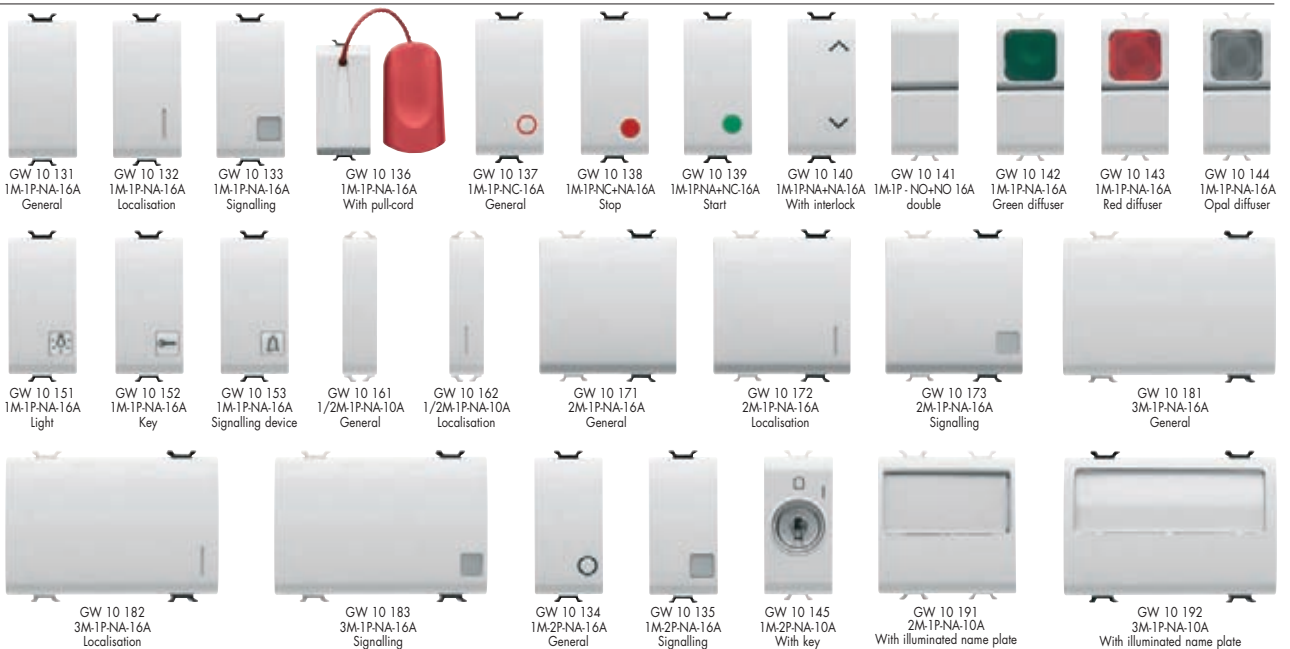

WHITE - COMMAND

RAPID WIRING ONE-WAY SWITCHES



GW 10 031
2M - 1P - 16AX
General



GW 10 032
2M - 1P - 16AX
Localisation



GW 10 033
2M - 1P - 16AX
Signalling



GW 10 034
2M - 2P - 16AX
General



GW 10 035
2M - 2P - 16AX
Signalling

RAPID WIRING TWO-WAY SWITCH



GW 10 071
2M - 1P - 16AX
General



GW 10 072
2M - 1P - 16AX
Localisation



GW 10 073
2M - 1P - 16AX
Signalling

RAPID WIRING REVERSING SWITCHES



GW 10 101
2M - 1P - 16AX
General



GW 10 102
2M - 1P - 16AX
Localisation



GW 10 103
2M - 1P - 16AX
Signalling

RAPID WIRING PUSH-BUTTONS



GW 10 171
2M - 1P - 16A
General



GW 10 172
2M - 1P - 16A
Localisation



GW 10 173
2M - 1P - 16A
Signalling

COMBINED DEVICES



GW 10 078
Double two-way switch
1P - 16AX



GW 10 159
Push-button 1P-NA-16A +
Two-way switch 1P-NA-16AX



GW 10 160
Double push-button
1P-NA-16A

LENSES WITH ILLUMINATED SYMBOLS



GW 10 501
Transparent symbol



GW 10 502
Light symbol



GW 10 503
Stair light symbol



GW 10 504
Bench light symbol



GW 10 505
Signalling device
symbol



GW 10 506
Fan symbol



GW 10 507
Key symbol



GW 10 511
Nurse symbol



GW 10 512
Chambermaid
Symbol



GW 10 508
Alarm symbol



GW 10 509
ON symbol



GW 10 510
OFF symbol



GW 10 513
Dimmer increase
symbol.



GW 10 514
Dimmer decrease
symbol



GW 10 515
Arrow up symbol



GW 10 516
Arrow down
symbol



GW 10 517
Arrow up-down
symbol



GW 10 518
Arrow rh-lh symbol



GW 10 531
Number One
symbol



GW 10 532
Number Two
symbol



GW 10 533
Number Three
symbol



GW 10 534
Number Four
symbol



GW 10 535
Number Five
symbol



GW 10 536
Number Six
symbol



GW 10 537
Number Seven
symbol



GW 10 538
Number Eight
symbol



GW 10 539
Number Nine
symbol



GW 10 540
Number Zero
symbol

INTERCHANGEABLE BUTTON KEYS



GW 10 541
General interchangeable
button key



GW 10 542
Interchangeable button
key with label



GW 10 543
Key interchangeable
button key



GW 10 544
Signalling device
interchangeable button
key



GW 10 545
Vert. arrow
interchangeable button
key



GW 10 546
Horiz. arrow
interchangeable button
key



GW 10 547
Red interchangeable
gem



GW 10 548
Green interchangeable
gem



GW 10 549
Opal
interchangeable gem



GW 10 550
Amber interchangeable
gem

BLANKING MODULES AND OUTLET



GW 10 195
1 Gang



GW 10 196
1 Gang with
Cable output



GW 10 197
1/2 Gang

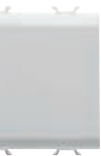

GW 10 198
2 Gangs



GW 10 199
3 Gangs

HOTEL COMPONENTS



GW 10 040
Universal badge switch
1 gang - NO - 16AX

IR



GW 10 591
IR movement
detector 1NA-3A



GW 10 592
Infrared movement detector
1NA-16A

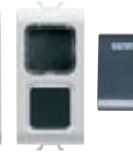

GW 10 597
1 channel receiver
230V ac 50/60Hz



GW 12 596
Portable 6
channel remote control

RELAY



GW 10 721
Step-step
1 gang - 10AX-
230V ac



GW 10 723
4 sequences
2 gangs -
10AX-230V cc



GW 10 724
Monostable
1 gang -
1NA NO

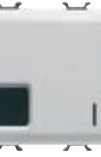

GW 10 725
Electronics for heavy-duty loads
1gang - 1NA-230V cc



GW 10 726
Call
1gang - 1NA NO
12V ac/dc

WHITE - ENERGY TAKE-OFF

ITALIAN									
	GW 10 201 2P+T 10A 250V ac	GW 10 203 2P+T 16A250V ac Dual amperage	GW 10 213 2P+T 16A250V ac Dual amperage	GW 10 223 2P+T 16A250V ac Dual amperage	GW 10 233 2P+T 16A 250V ac Dual amperage	GW 10 208 Rapid wiring 2x2P+T 16A- 250V ac	GW 10 209 Rapid wiring 3x2P+T 16A-250V ac Dual amperage		
ITALIAN/GERMAN									
	GW 10 204 2P+T 16A250V ac Dual amperage	GW 10 205 2P+T 16A 250V ac	GW 10 214 2P+T 16A250V ac Dual amperage	GW 10 224 2P+T 16A250V ac Dual amperage	GW 10 234 2P+T 16A250V ac Dual amperage				
GERMAN			SPANISH						
	GW 10 241 2P+T 16A 250V ac	GW 10 251 2P+T 16A 250V ac		GW 10 341 2P+T 16A- 250V ac front tightening terminals	GW 10 351 2P+T 16A - 250V ac front tightening terminals				
FRENCH									
	GW 10 246 2P 16A 250V ac	GW 10 247 2P+T 16A 250V ac	GW 10 247F 2P+T 16A - 250V ac front tightening terminals	GW 10 257F 2P+T 16A - 250V ac front tightening terminals	GW 10 260 Accessory for French socket allocated lines				
ISRAELI			USA		EURO-AMERICAN				
	GW 10 281 2P+T 16A 250V ac	GW 10 291 2P+T 16A 250V ac		GW 10 286 2P+T 15A 125V ac		GW 10 287 2P+T 15A 250/125V ac			
BRITISH			ARGENTINE			AUSTRALIAN			
	GW 10 296 2P+T 13A 240V ac	GW 10 297 2P+T 15A 240V ac		GW 10 301 2P+T 10A 240V ac	GW 10 302 2P+T 15A 240V ac		GW 10 306 2P+T 10A 250V ac	GW 10 307 2P+T 15A 250V ac	
INTERLOCKED SWITCHED SOCKET-OUTLETS					SHAVRER SOCKET-OUTLET				
	GW 10 311 2P+T 16A 230V ac	GW 10 312 2P+T 16A 230V ac	GW 10 321 2P+T 16A 230V ac	GW 10 322 2P+T 16A 230V ac					
							GW 10 331 Shaver socket-outlet 230V ac - 50/60 Hz		

WHITE - SIGNAL TAKE OFF

TV-SAT		Male IEC type GW 10 361 0db GW 10 362 5db GW 10 363 10db GW 10 364 14db GW 10 365 18db GW 10 366 22db GW 20 277 resistance 75ohm terminal		Female F type GW 10 371 0db GW 10 372 5db GW 10 373 10db GW 10 374 14db GW 10 375 18db GW 10 376 22db GW 20 277 resistance 75ohm terminal	TV-FM-SAT		GW 10 381 TV - FM 0dB		GW 10 382 TV-FM-SAT 0dB						
	<hr/>														
TELEPHONE JACKS		GW 10 401 RJ11		GW 10 402 RJ 11 IN/OUT		GW 10 403 RJ 11 double		GW 10 404 RJ 12		GW 10 405 French 8 contacts		GW 10 406 Israeli 6 contacts			
	<hr/>														
	CONNECTORS FOR STRUCTURED WIRING		GW 10 421 RJ45 5e UTP		GW 10 422 RJ45 5e FTP		GW 10 423 RJ45 6 UTP		GW 10 424 RJ45 6 FTP		GW 10 425 Bush ST O.F.		GW 10 426 Bush SC O.F.		GW 10 427 Bush MT - RJ O.F.
		<hr/>													
		CONNECTORS FOR CONVENTIONAL NETWORKS		GW 10 441 SUB - D 9 Contacts		GW 10 442 SUB - D 15 Contacts		GW 10 443 SUB - D 25 Contacts		GW 10 444 BNC 50 Ohm cable RJ58		GW 10 445 BNC 75/93 Ohm cable RJ59/62			
			<hr/>												
SELV SOCKETS				GW 10 451 2P - 6A 24V		GW 10 452 2P - 6A 24V Polarized	AUDIO AND VIDEO CONNECTORS		GW 10 453 Double RCA		GW 10 454 Sound circuits		GW 10 446 Female F coupling connector		
			<hr/>												

WHITE - PROTECTION AND SIGNAL

AUTOMATIC SWITCHES



GW 10 461 - 6A 230V ac
GW 10 462 - 10A 230V ac
GW 10 463 - 16A 230V ac
1P

Miniature circuit breakers
Breaking capacity 3kA
C curve



GW 10 482 - 6A 230V ac
GW 10 485 - 10A 230V ac
GW 10 488 - 16A 230V ac
1P+N I_{dn}=10mA

Differential miniature circuit
breakers
Breaking capacity 3kA
C curve - Class A

GW 10 483 - 6A 230V ac
GW 10 486 - 10A 230V ac
GW 10 489 - 16A 230V ac
1P+N I_{dn}=30mA

PROTECTION DEVICES



GW 10 491
Fuse holder
In MAX = 16A



GW 10 492
Overvoltage
limiter

ANTI BACK-OUT LAMPS



GW 12 661
Withdrawable
230Vac 50/60Hz



GW 10 666
Autonomous emergency lamp
230Vac 50/60Hz

RINGERS AND BUZZERS



GW 10 601
Ringer
12Vac 50Hz



GW 10 602
Ringer
230Vac 50Hz



GW 10 606
Buzzer
12Vac 50Hz



GW 10 607
Buzzer
230Vac 50Hz



GW 10 611
Ringer with three independent
inputs 12V ac/dc



GW 10 612
Ringer with three independent
inputs 230V ac/ 50Hz

INDICATOR LAMPS



GW 10 641
Single indicator
lamp 1/2
Opal module



GW 10 642
Single indicator
lamp 1/2
Green module



GW 10 643
Single indicator
lamp 1/2
Red module



GW 10 644
Single indicator
lamp 1/2
Amber module



GW 10 621
Single indicator
lamp 1
Opal module



GW 10 622
Single indicator
lamp 1
Green module



GW 10 623
Single indicator
lamp 1
Red module



GW 10 624
Single indicator
lamp 1
Amber module



GW 10 628
Double indicator
lamp 1
Opal module



GW 10 629
Double indicator
lamp 1
Red/Green module



GW 10 629
Double indicator
lamp 1
Red/Green module

PROTRUDING INDICATOR LAMPS



GW 10 631
Opal
12V ac/dc - 230V ac



GW 10 632
Green
12V ac/dc - 230V ac



GW 10 633
Red
12V ac/dc - 230V ac



GW 10 634
Amber
12V ac/dc - 230V ac

STAIR RISER LAMPS



GW 10 651
2M Opal



GW 10 656
4M Opal

ENERGY MANAGEMENT, COMFORT AND CLIMATE - TECHNICAL ALARMS - REMOTE CONTROLS - WHITE

CLOCK/ ALARM/THERMOMETER



GW 10 708
Clock / alarm / thermometer
230Vac - 50/60 Hz

TIMER DEVICES



GW 10 581
Electronic daily/weekly timer
230Vac - 50/60 Hz



GW 10 582
Relay timer



GW 10 583
Electronic timer

CLIMATE CONTROL



GW 10 703
Timer thermostat
230Vac - 50/60 Hz



GW 10 701
White wall-mounting timed thermostat
GW 14 701
Titanium wall-mounting timed thermostat



GW 10 705
Thermostat
230Vac - 50/60 Hz

DIMMER



GW 10 561
Res.100-500W
230V ac



GW 10 564
Res.100-900W
Ind.40-300VA
230V ac - 12V ac/dc



GW 10 567
Res.100-500W
With two-way switch
230V ac - 12V ac/dc



GW 10 568
Res.60-500W
Ind.60-500VA
230V ac



GW 10 571
For electronic transformers
230V ac



GW 10 574
For air agitators
55-80VA
230V ac

TECHNICAL ALARMS



GW 10 711
LPG detector - 12V ac/dc



GW 10 712
METHANE detector -
12V ac/dc



GW 10 716
Water detector - 12V ac/dc



GW 12 718
RF water sensor



GW 10 719
Power supply unit
230V ac - 12V dc

REMOTE CONTROLS



GW 90 821
GSM remote control with I/O
and serial line
6 DIN modules



GW 90 822
GSM remote control interface
- RF command/control
1 DIN module



GW 90 823
GSM remote control interface -
RF burglar alarm device -
3 DIN modules

LED SIGNALLING UNIT



GW 10 881 Blue
GW 10 882 White
GW 10 883 Red
GW 10 884 Green
GW 10 885 Amber
230Vac - 50/60 Hz

INCANDESCENCE SIGNALLING UNIT



GW 10 891
12Vac / dc, 0,4W
GW 10 892
24Vac / dc, 0,8W
white light emission

CARTRIDGE LAMPS



GW 20 902 S6 x 36 12V White
GW 20 903 S6 x 36 24V White

KEYS



GW 20 901
for GW 10 006 and GW 10 054
GW 30 912 for GW 10 145